

# APPLICATION FOR A PERMIT TO CONSTRUCT A WATER WELL IN THE LITTLE BLUE NATURAL RESOURCES DISTRICT

1. NAME: Steve K Gebers Dave L Gebers  
ADDRESS: 4061 Road 1A  
Noray, Nebraska 68961  
Phone No. (402) 621-0172

DWR & NRD Use Only

Permit No. LBMA-1776  
Reg. No. G-163041

CB#036951

## 2. PURPOSE OF WELL: (check one)

☒ Irrigation ☐ Industrial ☐ Dewatering (over 90 days) ☐ Aquaculture  
☐ Domestic ☐ Geothermal ☐ Groundwater Source Heat Pump ☐ Ground Heat Exchanger  
☐ Livestock ☐ Recovery ☐ Public Water Supply  
☐ Monitoring ☐ Other (Specify) \_\_\_\_\_

## 3. IDENTIFY THE LOCATION OF THE WELL:

Mac Kolls County, Section (by quarter) NWSE4 1  
Township 2 North Range 5 East or West

Well is 2600 feet from the North/South Section Line or Latitude \_\_\_\_\_ North  
and 2600 feet from the East/West Section Line or Longitude \_\_\_\_\_ West

The box at the right represents one square mile, (section). Indicate with an "X", the proposed location of the well, please highlight the proposed water-use area. If water is to be used outside the above-written legal description, give legal description of water-use area below.

Section (by quarter) NW 01 Township 2 North, Range 5 East/West

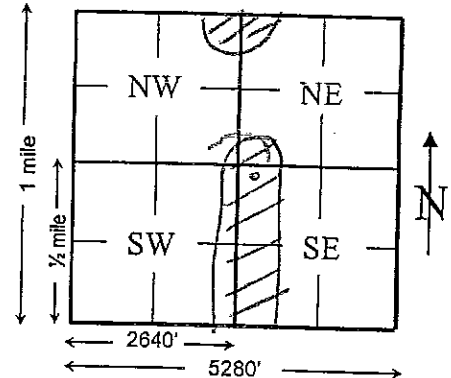

## 4. IRRIGATION WELLS:

How many acres will be irrigated? 45 Will flow meter be used on the well? NA  
Type of irrigation system? ☒ Center Pivot ☒ Gravity ☐ Other (specify) \_\_\_\_\_  
Will system be ☐ Electric ☒ Fuel Powered?  
Will the well be used in a system with other wells? ☐ Yes ☒ No? If yes, how Many? \_\_\_\_\_  
Will fertilizer, chemicals or animal waste be applied through the system ☐ Yes ☒ No?

## 5. REPLACEMENT AND ABANDONMENT WELL INFORMATION:

Is this a replacement well? ☐ Yes ☒ No  
Registration Number of well to be replaced: \_\_\_\_\_  
Well to be replaced was last operated on \_\_\_\_\_  
Replacement well is \_\_\_\_\_ feet from original well.  
Original well will be decommissioned approximately on \_\_\_\_\_ (must be within 180 days of completion of new well)  
Replacement well must water the same tract of land as the decommissioned well.

## 6. SPECIFICATIONS OF WELL AND PUMP:

Date when construction will begin: May, 2012  
Pump column diameter: 8.62 inches. Total well depth: 220 feet.  
Estimated pumping capacity: \_\_\_\_\_ gallons per minute. Well casing diameter \_\_\_\_\_ inches.

Please attach test hole log, if available. Name of Well Driller: Shuck Drilling Co.

7. I certify that I am familiar with the information contained in this application and its restrictions, rules and land regulations; and that to the best of my knowledge and belief, such information is true, complete and accurate. I understand that if specific conditions are applied to this permit, a notice of encumbrance may be filed on the title of the land.

This form must be completed in full and be accompanied by a non-refundable \$50.00 filing fee payable to the Little Blue Natural Resources District.

March 29, 2012  
Date

4/6/12  
Date Approved

Steve K. Gebers  
Signature of Applicant

Kim G.  
NRD Representative

NRD Representative

SEE OTHER SIDE FOR IMPORTANT PERMIT RESTRICTIONS, RULES AND REGULATIONS!!!!

non-conditional